

PARTS & INSTALLATION INSTRUCTIONS

E-60 QUIK-LIFT®

LIFT CYLINDER UPDATE KIT

PARTS LIST

ITEM	STANDARD-UP THROUGH C-9 1-1/8" x 6" Stroke E-60	QTY.	DESCRIPTION
	08839	1	UPDATE KIT E-60
1	15125	1	• O-ring 7/16" I.D.
2	15158	1	• Piston
3	15162	1	• Packing Cup
4	15219	1	• Piston Follower
5	20316	1	• Locknut 1/2-13
6	15953	1	• Cylinder 1-3/4" I.D.
7	15198	1	• O-Ring 1-1/8 I.D.
8	15163	1	• O-ring 1-15/16 I.D.
9	21929	3	• Washer, Nyltite 5/16
10	20697	3	• Locknut 5/16-24

Parts indented are included in assembly under which they are indented.

DISSASSEMBLY

1. Drain Oil from Hydraulic Unit.
2. To disassemble Cover Assembly, remove the three Locknuts (10) and Nyltite Washers (9). See Figure 1.
3. Tap Cover Assembly up and off reservoir. If O-ring (7) came off with top cap discard it. This O-ring will not be reused.
4. Remove Lift Ram Assembly from Sump base. Remove O-ring (8) in bottom of Sump Casting. It will not be reused.
5. Remove chrome Ram Assembly from Lift Cylinder (6). Cylinder will not be reused.
6. To disassemble Lift Ram Assembly, remove nut (5), brass piston with packing cup, flatwasher and O-ring.
7. The O-ring, Brass Piston with packing cup, flatwasher and nut will not be reused.

Note: The Chrome Lift Ram will be resued.

REASSEMBLY

1. Assemble O-ring (1), Piston (2), Packing Cup (3), and Piston Follower (4) to Chrome Ram. Secure parts with nut (5). See Figure 1
2. Assemble Lift Ram Assembly into Lift Cylinder. Coat Piston Assembly with oil. Slide the Ram Assmbly from the bottom up into cylinder (6).
3. Tap Ram Assembly up into Cylinder (6) making sure that no damage occurs to threads at the end of ram assembly or to bottom of cylinder (6) where O-ring (8) will sit.
4. Assemble washer with grooves facing downward onto chrome ram followed by O-ring (7).
5. Assemble O-ring (8) in bottom of sump casting. Set Lift Ram Assembly squarley into sump base.
6. Assemble Cover Assmbly onto Lift Ram. Coat Cover Assembly O-ring with oil. Tap Cover Assembly down securley to reservoir.
7. Assemble Nyltite Washers (9) over studs bevel down.
8. Secure Cover Assembly with nuts (10). Torque nuts to 125 in.lbs.
9. Refill Hydraulic Unit with oil. Oil level is 1" to 1-1/2" from top.

NOTE: RESET PRESSURE RELIEF TO 2000 ± 50 P.S.I.

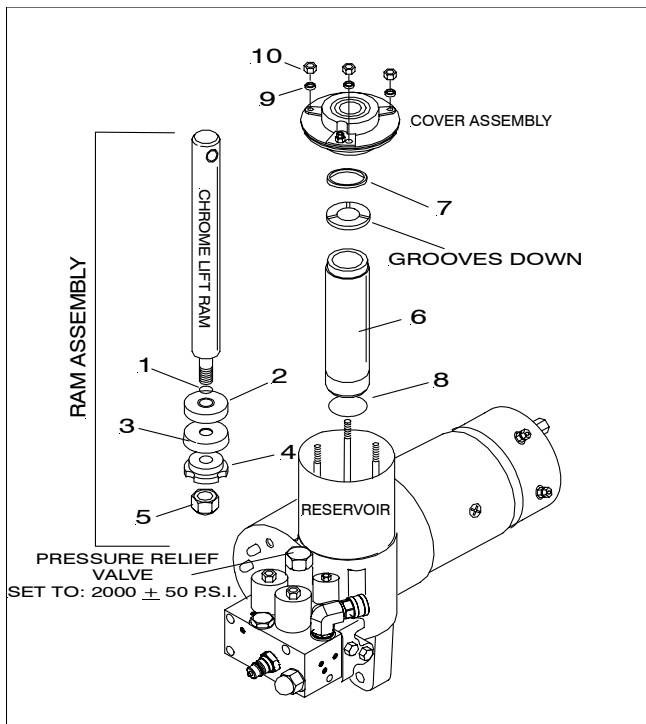

FIGURE 1

Meyer Products reserves the right, under its continuing product improvement program, to change construction or design details, specifications and prices without notice or without incurring any obligation.